



Indoor fixed dome camera mounts

Our new range of fixed and PTZ dome mounts provide a rugged solution for our CCTV cameras. The mounts are discrete, durable and come with a smooth finish to complement the cameras. They have been designed with easy installation in mind and can all be installed with just a few simple steps.

WM-IFD

Wall mount for VN-T216U, VN-H237U/UA and VN-H257U/UA indoor fixed dome cameras.



PM-IFD

Pendant mount for VN-T216U, VN-H237U/UA and VN-H257U/UA indoor fixed dome cameras.

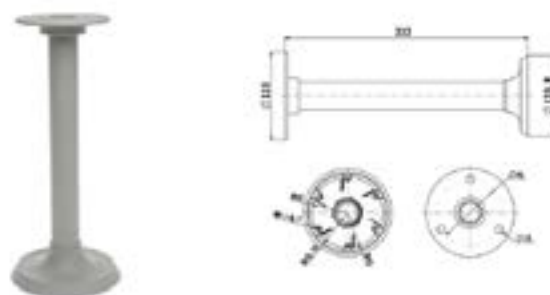

RC-IFD

Recessed ceiling mount dome housing for the VN-T216U, VN-H237U/UA and VN-H257U/UA indoor fixed dome cameras. Plemun rated.



WB-S2205U

Recessed ceiling mount dome housing for the VN-H237U/UA and VN-H257U/UA indoor fixed dome cameras. Non-plemun rated.





Outdoor fixed dome camera mounts

RC-VPOD

Recessed ceiling mount dome housing for the VN-T216VPRU, VN-H237VPU/UA and VN-H257VPU/BU outdoor

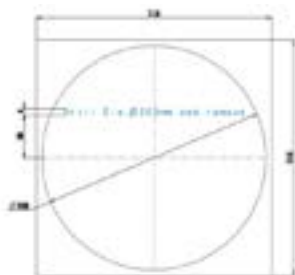

POLEM-VPOD

Pole mount adaptor for WM-VPOD outdoor wall mount. Supported pole diameter - max 160mm, min 80mm.

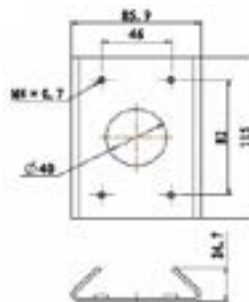

JB-VPOD

Junction box mount for VN-T216VPRU, VN-H237VPU/UA and VN-H257VPU/BU outdoor fixed dome cameras.

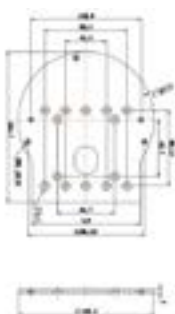



Outdoor fixed dome camera mounts (continued)

WM-VPOD

Wall mount for VN-T216VPRU, VN-H237VPU/UA and VN-H257VPU/BU outdoor fixed dome cameras.



PM-VPOD

Pendant mount for VN-T216VPRU, VN-H237VPU/UA and VN-H257VPU/BU outdoor fixed dome cameras.

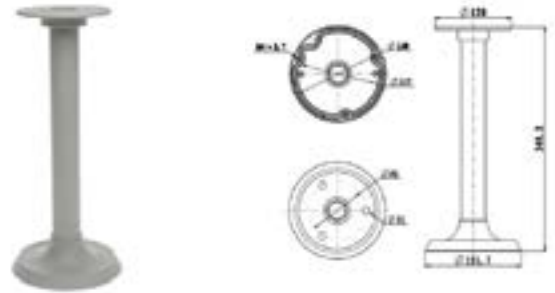

PMTK-C205WA

Pendant mount for VN-T216VPRU, VN-H237VPU/UA and VN-H257VPU/BU outdoor fixed dome cameras. Pole not included (uses US standard 3/4 inch NPT pipe for customized lengths).

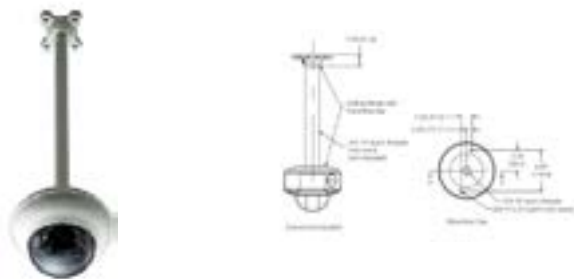



Fixed dome camera pendant mount extensions

PM-EXT1

Pendant mount extension (1 foot) for use with PM-IFD and PM-VPOD pendant mounts.

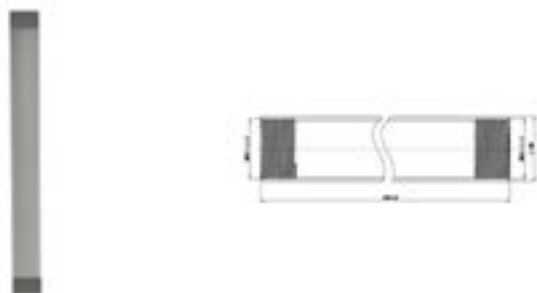

PM-EXT3

Pendant mount extension (3 feet) for use with PM-IFD and PM-VPOD pendant mounts.

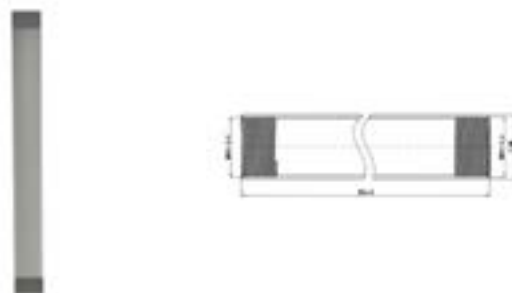

JVC



Indoor PTZ dome camera mounts

Simple to install and designed for both video and network cameras, there are various internal and external bracket options to fit our selection of network PTZ cameras.

WB-S682F

Wall mount for VN-V685U, VN-V686BU and VN-H657U indoor PTZ dome cameras.

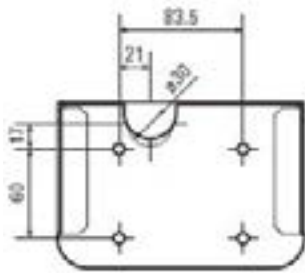

WB-S681U

Pendant mount for VN-V685U, VN-V686BU and VN-H657U indoor PTZ dome cameras.

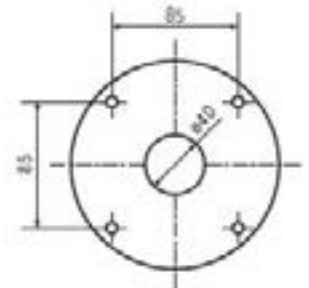

RC-IPTZ

Recessed ceiling mount dome housing for VN-V685U, VN-V686BU and VN-H657U indoor PTZ dome cameras.

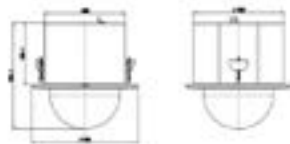

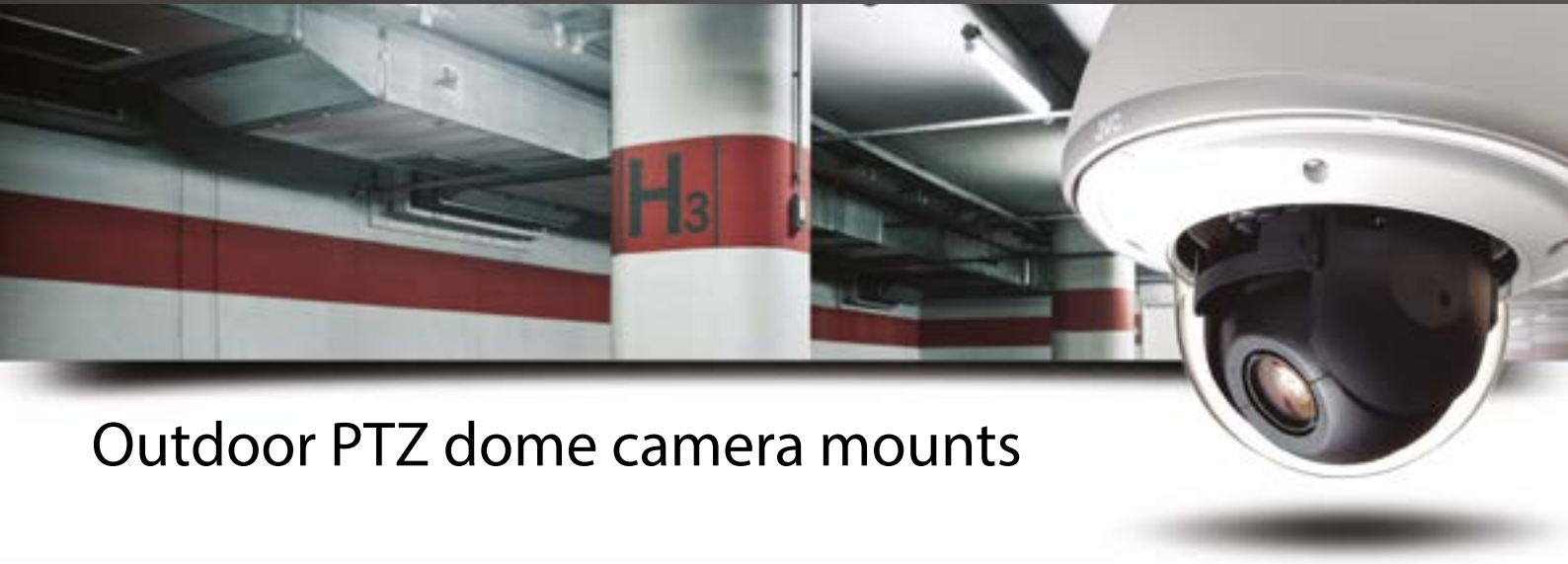

Outdoor PTZ dome camera mounts

WB-S684U

Pendant mount for VN-V686WPBU and VN-H657WPU/BU outdoor PTZ dome cameras.



PARM-OPTZ

Parapet mount for VN-V686WPBU and VN-H657WPU/BU outdoor PTZ dome cameras.

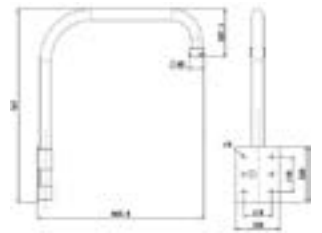

CM-OPTZ

Corner mount for VN-V686WPBU and VN-H657WPU/BU outdoor PTZ dome cameras.

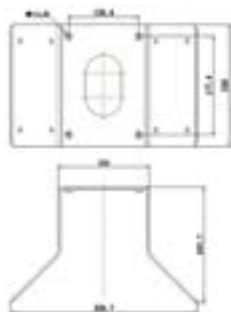

POLEM-OPTZ

Pole mount adaptor for VN-V686WPBU and VN-H657WPU/BU outdoor PTZ dome cameras.
Supported pole diameter - max 160mm, min 80mm.

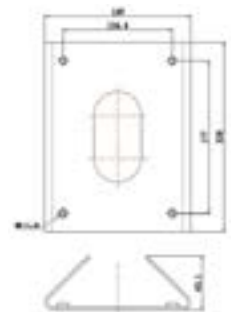

JVC